



325 COMMERCE DRIVE  
 MT VERNON, OH 43050  
 800-253-8236

# SPECIFICATION DATA SHEET

DATE: 5-14-13  
 PREPARED BY: RL

## MODEL NO. 020

### DUCTBOARD START COLLAR W/DAMPER

6 1/4" BODY - STANDARD MODEL

#### DIMENSIONS

| SIZE | DUCTBOARD SIZE |     |          |
|------|----------------|-----|----------|
|      | A              | B   | C        |
| 4"   | 4"             | 6"  | 1" OR 2" |
| 5"   | 5"             | 7"  | 1" OR 2" |
| 6"   | 6"             | 8"  | 1" OR 2" |
| 7"   | 7"             | 9"  | 1" OR 2" |
| 8"   | 8"             | 10" | 1" OR 2" |
| 9"   | 9"             | 11" | 1" OR 2" |
| 10"  | 10"            | 12" | 1" OR 2" |
| 12"  | 12"            | 14" | 1" OR 2" |
| 14"  | 14"            | 16" | 1" OR 2" |
| 16"  | 16"            | 18" | 1" OR 2" |

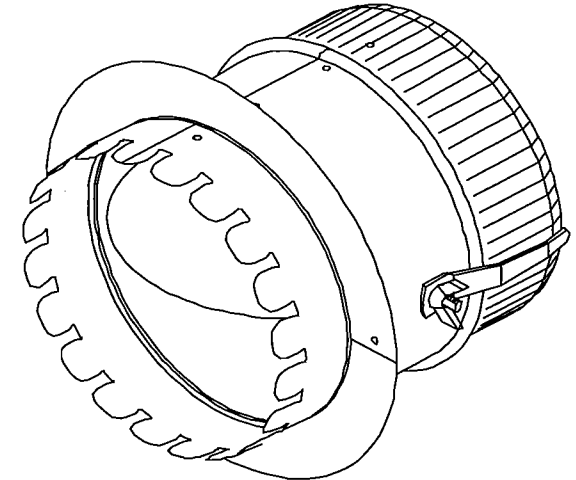
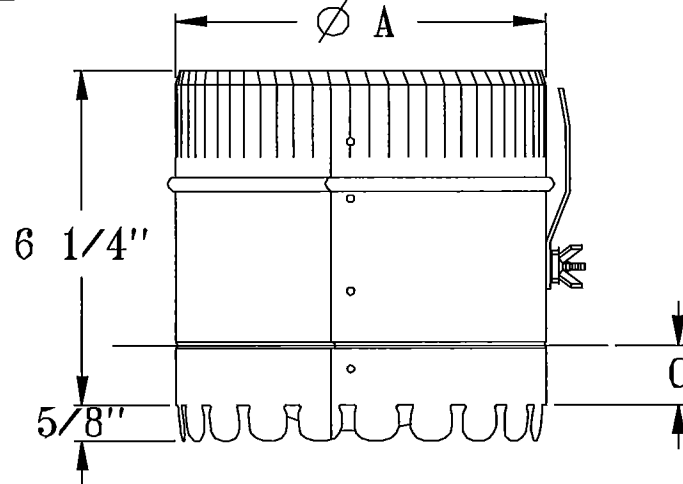

#### MATERIAL SPECIFICATIONS

HOT DIPPED GALVANIZED STEEL.

PER ASTM A 653 CSB.

ASSEMBLED WITH 1/8" ZINC COATED RIVETS.

BODY: 4"-8" = STD GA

BODY: 9"-16" = 28 GA

OTHER GAUGES AVAILABLE.

DAMPER: 4"-8" = 28 GA

DAMPER: 9"-12" = 26 GA

DAMPER: 14" & UP = 24 GA

RINGS: 4" - 6" = 28 GA

RINGS: 7" - 10" = 26 GA

RINGS: 12" & UP = 24 GA

WINGNUT = 5/16-18, ZINC PLATED STEEL

DAMPER HANDLE = 18 GAUGE

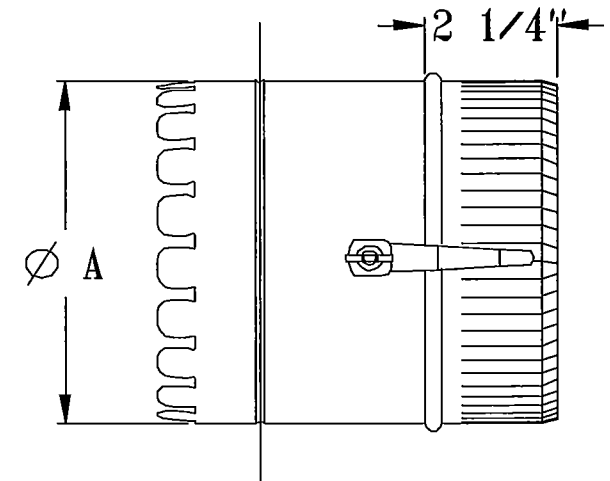
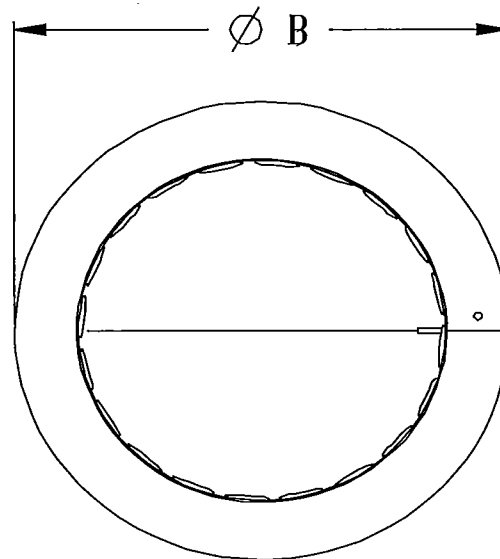

#### OPTIONS

AVAILABLE WITH 5" WIDE BODY

AVAILABLE WITH 2" ECONOMY STAND-OFF

JOB: \_\_\_\_\_  
 LOCATION: \_\_\_\_\_  
 CONTRACTOR: \_\_\_\_\_  
 ENGINEER: \_\_\_\_\_  
 NOTES: \_\_\_\_\_