

# Heating Components

Compressors, Chillers, Condensers  
Motors  
Electrical  
Heating Components  
Indoor Air Quality  
Thermostats  
Oils & Chemicals  
Accessories, Supplies & Commodities  
Tools & Instruments  
Refrigeration

## GLOW COILS

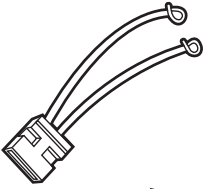

This is the replacement ignition coil for the 2H pilot burner supplied in the LH68006 pile package. Use with 48DA660025 resistance wire package.

PART NO	PILOT STYLE	NOM VOLTS
LH39JZ051	2H	10

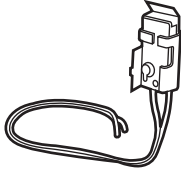

This igniter coil assembly is used with pilot burners LH68005 and LH33JZ053 glow coil voltage source must be limited to maximum of 11 volts.

PART NO	PILOT STYLE	NOM VOLTS
LH39JZ020	740	10

## UNIVERSAL THERMOCOUPLE

- Replaces almost any 30 mV thermocouple.
- Average operating life of ten years.
- Bottom lock design allows for one hand installation.
- Universal adapter makes this the two-to-one installer-preferred thermocouple in independent HVAC survey.

PART NO	HONEYWELL PART NO	DESCRIPTION
P671-Q340A-18	A340A1066	Thermocouple 18.
P671-Q340A-24	Q340A1074	Thermocouple 24.
P671-Q340A-30	Q340A1082	Thermocouple 30.
P671-Q340A-36	Q340A1090	Thermocouple 36.
P671-Q340A-48	Q340A1108	Thermocouple 48.

## PILOT SAFETY SWITCHES

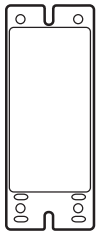

- Solid state lockout timer
- 30 second trial for ignition
- May be reset after 30 sec.
- 24 volt input

PART NO	MODEL NUMBER
HH72CH003	9901141

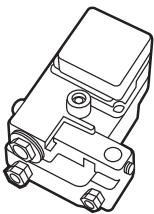

Manual reset pilot control which shuts off gas to pilot and main burners when pilot flame fails. Includes pilot gas filter. Use with nominal 30 mV thermocouple.

PART NO	MODEL NUMBER	TUBE SIZE
EF53FB020	C591A	1/4 O.D. "

## RESISTORS

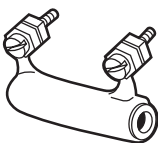

Resistors and resistance wire are required on some units to reduce the voltage to ignition glow coils. Refer to unit installation and service instructions.

PART NO	OHMS RESISTANCE	WATTS
HT21AU004	4	20
HT21AU020	5	20
55939D5	3	8

## RESISTANCE WIRE



This package contains stainless resistance wire used in reducing the 24 volt power source to nominal 9-11 volts required on some glow coil igniters. Instruction sheet included.

PART NO	LENGTH (in)	OHMS PER FT
48DA660025	156	0.38

## IGNITION LEADS

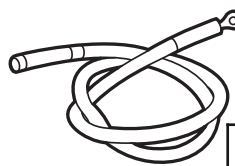

High Voltage Ignition Lead Silicone insulated wire for ignition systems where high temperature, moisture resistant ignition lead is required on outdoor equipment.

PART NO	END CONNECTIONS	WIRE LENGTH (in)
48MA403742	SPK. PLUG/RING TERM.	20
B0805050	SPARK PLUG	24
48DD410452	Q.C./PIN TERM.	24
301286-702	NONE	27
RM680002	QUICK CONNECT	24

## LOW PRESSURE SWITCH

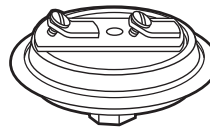

These low pressure switches are used in ignition circuits to interrupt power when gas pressure is low or gas service to unit is shut down. Switch has 1/8" NPT connection on underside.

PART NO	RATING	PRESS SETTING
HK02LB005	1 AMP	2 WC "
HK02LB018	1 AMP	6 WC "

## COMBUSTION BLOWER ASSEMBLY

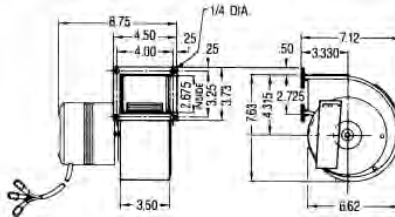

- 100 CFM Max.
- 230 Volt
- 1/10 H.P.
- PSC motor
- 3450 RPM

PART NO
48DA660

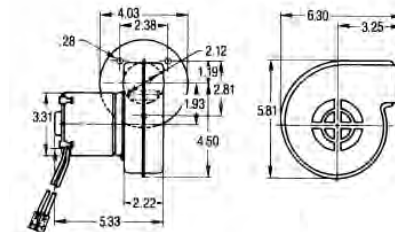

- 60 CFM Max.
- 230 Volt
- 1/80 H.P.
- Shaded pole motor
- 3200 RPM

PART NO
LA25UZ0

## OIL BURNER COMPONENTS

### OIL PUMPS

- Compact size
- 5/16" dia. shaft
- Integral bleed fitting for easy start up

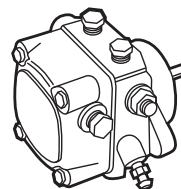

PART NO	PUMP STAGES	PUMP RPM
58HH680027	1	1725
58HH680029	2	1725
58HH680001	1	3450
58HH680002	2	3450