

# BR70 STANDARD



## INDOOR UNIT Duct Mounted or Thru-the-Wall



### SPECIFICATIONS

**Ventilation Type:**  
Static plate, heat and humidity transfer

**Typical Airflow Range:** 40-70 CFM

**Standard Features:**  
Painted cabinet  
Line-cord power supply  
Built-in control  
Unit may be mounted in any orientation

**Control:**  
Built-in proportional runtime control and switched terminals for furnace/AC interconnect

**Filters:**  
Total qty. 2, MERV 8, spun-polyester media:  
7 1/2" x 10 1/2" x 1"

**Unit Dimensions & Weight:**  
29 3/4" L x 19 1/4" W x 10 3/4" H  
38 lbs.

**Max. Shipping Dimensions & Weight (in carton):**  
30" L x 22" W x 15" H  
50 lbs.

**Motor(s):**  
Qty. 1, Double-shaft standard motor

**Accessories:**  
Backdraft damper 6"  
Wall cap 6" - white, brown  
Exterior thru-the-wall installation kit  
Duct collar kit

**Note:** Electric Duct Heater is not available on the BR70.

### ELECTRICAL DATA

HP	Volts	HZ	Phase	Input Watts	FLA
0.08	120	60	Single	94 @ 69 CFM	1.0

### UNIT PERFORMANCE

Airflow CFM	ESP in H <sub>2</sub> O
46	0.40
59	0.30
73	0.20
86	0.10

### CORE PERFORMANCE

Temp EFF%	Total EFF% Winter/Summer*
80	75/62
77	72/58
75	69/54
72	66/51

\* See performance ratings per CSA C439 on page 135 of RenewAire's Full Line Volume XVI Catalog.

### UNIT DIMENSIONS

**AIRFLOW CONFIGURATION**  
Available as shown in dimension drawing.

**UNIT MOUNTING & APPLICATION**  
Can be mounted in any orientation. If duct-mounted, airstreams cannot be switched. If mounted with exterior Thru-the-wall installation kit, the RA/EA airstreams are switched with the OA/FA airstreams. If four ducts are connected using duct collar kit, airstreams may be switched.

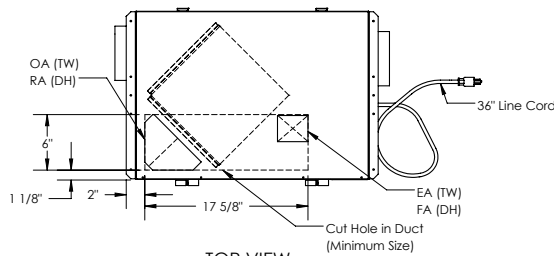

**ABBREVIATIONS**  
EA: Exhaust Air to outside  
OA: Outside Air intake  
RA: Room Air to be exhausted  
FA: Fresh Air to inside  
TW: Thru Wall  
DH: Duct Hung

**INSTALLATION ORIENTATION**  
Unit may be installed in any orientation.

**NOTE**  
1. UNLESS OTHERWISE SPECIFIED, DIMENSIONS ARE ROUNDED TO THE NEAREST EIGHTH OF AN INCH.  
2. SPECIFICATIONS MAY BE SUBJECT TO CHANGE WITHOUT NOTICE.

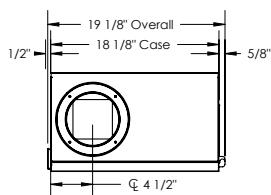

LEFT VIEW

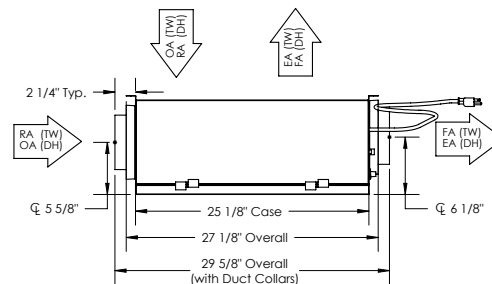

FRONT VIEW

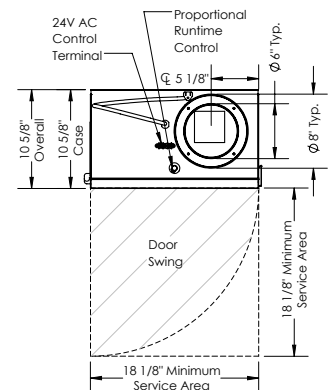

RIGHT VIEW

Specifications may be subject to change without notice.