

SUPERSTOR SOLAR SB MODELS (w/Boiler Back-up)

PARTS BREAKDOWN

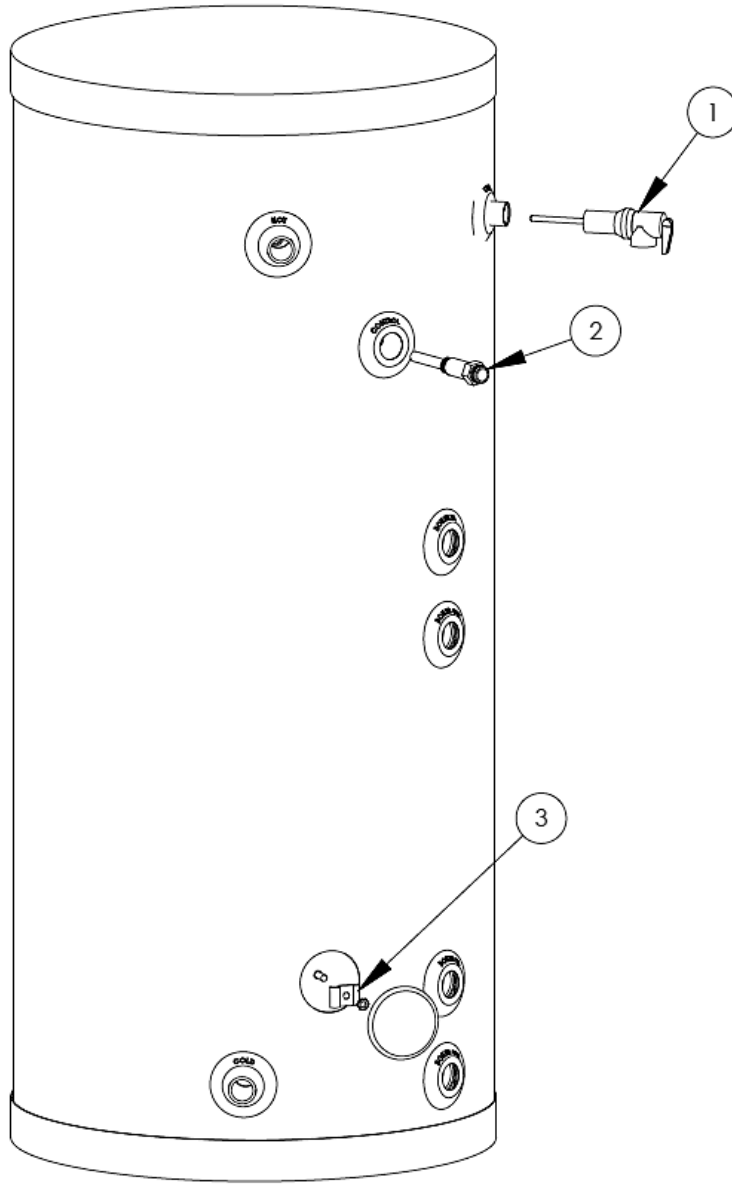

LP-199-E
08/20/13

Figure 13 - SB Model Parts Breakdown

Item No	Replacement Part #	Description	QTY.
1	TP1400	3/4" RELIEF VALVE (80 and 119 GAL ONLY)	1
2	PMW-3SENP-1	STAINLESS STEEL CONTROL WELL	1
3	8600P-054	SENSOR CLIP W/ NUT	1

Table 5 - SB Model Replacement Parts List

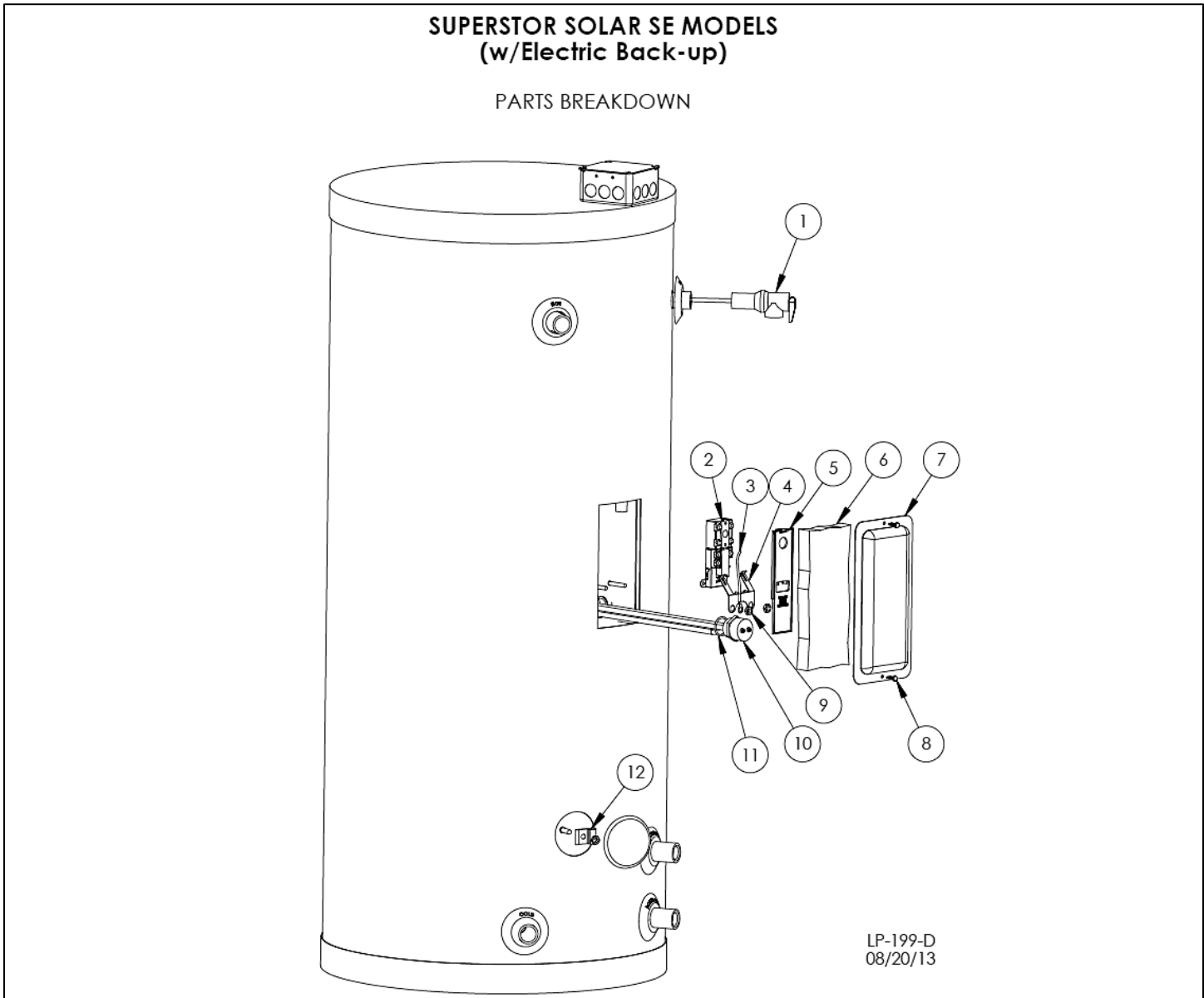

Figure 14 – SE Model Parts Breakdown

Item #	Replacement Part #	Description	Qty.
1	TP1400	3/4" RELIEF VALVE	1
2	6060P-817	THERMOSTAT	1
3	6060P-630	GREEN GROUND WIRE (w/RING)	1
4	6060P-633	THERMODISC MOUNTING CLIP	1
5	6060P-636	PLASTIC PROTECTIVE COVER	1
6	6060P-635	MINERAL WOOL INSULATION	1
7	6060P-187	ELECTRICAL ENCLOSURE COVER	1
8	6075P-006	#8 X 3/4 SELF TAPPING SCREWS - ELECTRICAL COVER	2
9	6060P-632	5/16-18 HEX NUT - THERMODISC MOUNTING CLIP	2
10	E1001	ELECTRIC ELEMENT (w/O-RING)	1
11	N/A	O-RING (#213 EDPM)	
12	8600P-054	SENSOR CLIP W/ NUT	1

Table 6 – SE Model Replacement Parts List

NOTE: If the heating element needs replacement, it is VERY important to use the same voltage, wattage, and construction. When replacing element, use only HTP part # E1001. Use of a generic element may lead to early replacement element and/or water heater failure, and WILL VOID the warranty.