

# QwikSwap® Azure® Variable Speed Motor Adapter

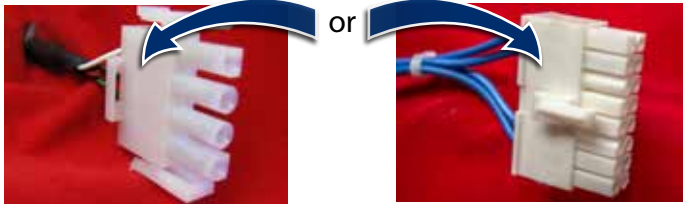

## For 4 Pin Connectors or 16 Pin Connectors with only 4 wires

*(Use other instructions for 16 pin connector with more than 4 wires)*

This board is for use with the Azure® MARS No. 10865 (1/3 and 1/2 HP) and 10866 (3/4 and 1 HP) ECM motors. These motors use line voltage speed taps and connect to the QwikSwap® board at the motor outputs. No capacitor is required. The optional hand held programmer (MARS No. 08502) can plug into the Azure® motor to fine tune the CFM provided by the 3 speed output of the QwikSwap® board.

### 1 Determine Motor Voltage

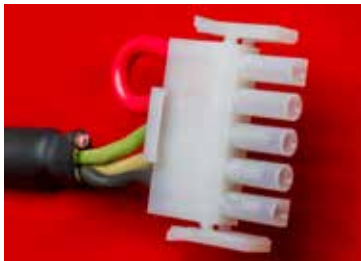

**Jumper Wire -**  
Set Azure® motor  
for 120V operation



**No Jumper Wire -**  
Set Azure® motor  
for 240V operation

then... With **power off**, remove the **16-pin** or **4-pin** signal connector (*with more than 4 wires*) from defective ECM motor and plug it into mating connection on the QwikSwap® board.

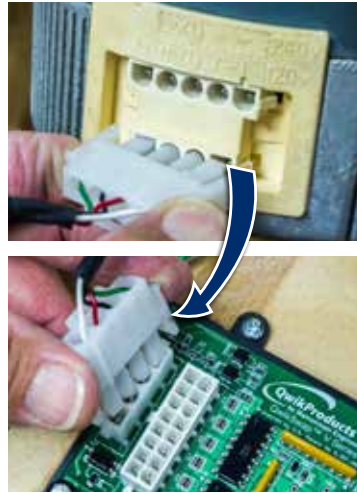

4-pin  
Connector  
from Motor  
to  
QwikSwap®  
Board

### 2 Connect the QwikSwap®

With **power off**, remove the **5-pin** power and **4-pin** signal connectors from defective ECM motor and plug them into mating connections on the QwikSwap® board.



5-pin  
Connector  
from Motor  
to  
QwikSwap®  
Board

or...

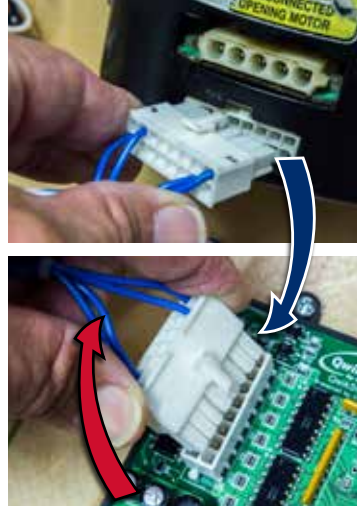

16-pin/4 wire  
Connector  
from Motor  
to  
QwikSwap®  
Board

**More than 4 wires on this 16-pin connector?  
Use the other instructions!**

**IF THE PLUGS DON'T FIT YOU'RE USING THE WRONG QWIKSWAP,  
NEVER CUT THE CONNECTORS OFF!**

**Flip over to the back of this sheet,  
there's a few more steps**

# QwikSwap® Azure® Variable Speed Motor Adapter

## 3 Select the Horsepower

Use the Configuration Switches on the Board to select the horsepower of the defective ECM motor.



Note the direction of **ON/OFF** in the Figure.

**NOTE:**  
**OFF** position is indicated by a **down arrow** at the left of the set!

CONFIGURATION SWITCH NUMBER & POSITION								
H.P.	1	2	3	4	5	6	7	8
1/3	ON	ON	ON	OFF	OFF	OFF	OFF	OFF
1/2	ON	ON	ON	ON	OFF	OFF	OFF	OFF
3/4	ON	ON	ON	ON	ON	ON	OFF	OFF
1	ON	ON	ON	ON	ON	ON	ON	ON

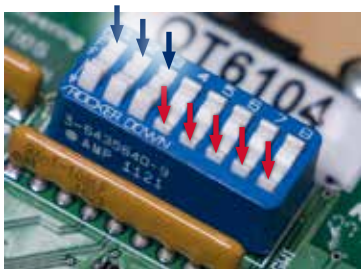

In this figure the motor has been set to 1/3 hp: **(ON, ON, ON, OFF, OFF, OFF, OFF, OFF)**

## 4 Verify Proper Operation & Lock in Settings

- a **Reconnect power to the air handler.** A flashing **Yellow** status LED and solid **Red** (COM) LED indicate proper communication.



If the **Yellow** LED is off, verify power to the QwikSwap® board. If the **RED** LED is off or flashing, there is a communication error.

- b **Lock in the Configuration.** With power still being supplied to the QwikSwap® board, set all configuration switches to **OFF**.

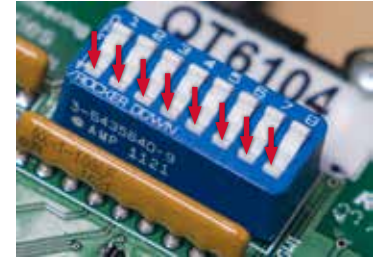

- c **Set the Fan to On.** Following a short delay, the **Green** (HIGH) LED should initially light and then settle on one of the (HIGH), (MED) or (LOW) LEDs.



- d **Set the Fan to Off.** Following a short delay, all the **Green** LEDs should turn **off**.

## 5 Install the Replacement Azure® Motor (same rotation and voltage)

- a Install the replacement Azure® motor, mount the QwikSwap® board.
- b Connect the Azure® motor common wire to the **MOTOR COM** terminal on the QwikSwap® board.
- c Connect the three Azure® motor speed taps to the corresponding terminals on the QwikSwap® board. See table below.



HP	Motor	Low	Med	High
1/3	10865	Purple	Gray	Yellow
1/2	10865	Gray	Yellow	Red
3/4	10866	Purple	Gray	Yellow
1	10866	Gray	Yellow	Red

**Technical Support**  
 M-F 8AM – 5PM Eastern • (800)-678-9888