



325 COMMERCE DRIVE
 MT VERNON, OH 43050
 800-253-8236

SPECIFICATION DATA SHEET

DATE: 5-20-13
 PREPARED BY: RL

MODEL NO. 132

TAKE OFF W/TABS

STANDARD MODEL

DIMENSIONS

SIZE	A	B	C	D	E	F	G	H
4"	4"	5"	4"	5 1/4"	6 1/4"	9 5/8"	2"	4"
5"	5"	6"	5"	6 1/4"	7 1/4"	10 1/2"	3 1/8"	5"
6"	6"	6"	6"	7 1/4"	7 1/4"	10 5/8"	3 1/4"	6"
7"	7"	7"	7"	8 1/4"	8 1/4"	11 5/8"	3 3/4"	7"
8"	8"	8"	8"	9 1/4"	9 1/4"	12 5/8"	4 7/16"	8"
8x10x8	8"	10"	8"	9 1/4"	11 1/4"	14 5/8"	4 7/16"	8"
10"	10"	10"	10"	11 1/4"	11 1/4"	14 5/8"	4 7/8"	10"

No Rise

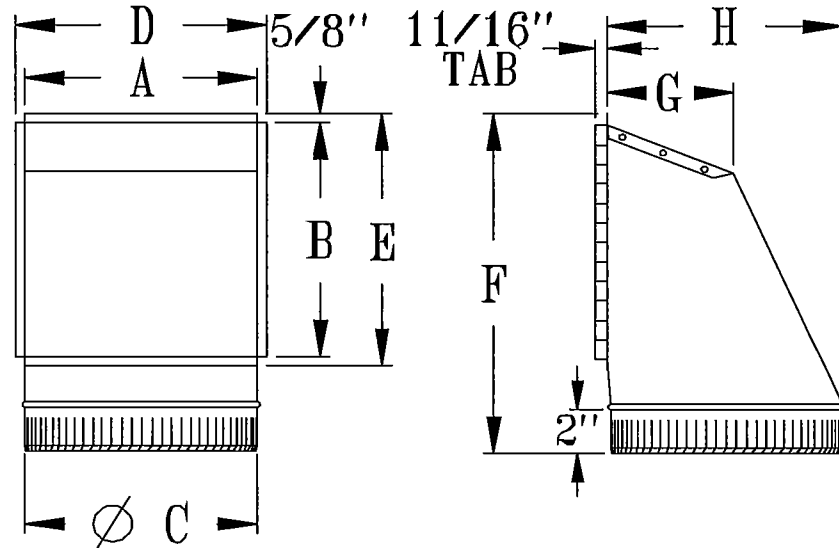
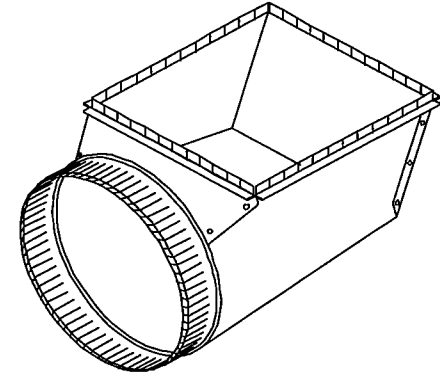
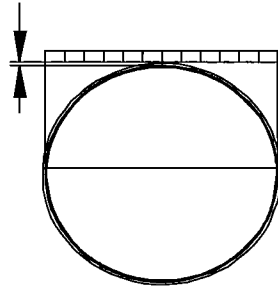

MATERIAL SPECIFICATIONS

HOT DIPPED GALVANIZED STEEL.
 PER ASTM A 653 CSB.

BODY & COLLAR: 4" - 8" = STD GAUGE
 BODY & COLLAR: 9" - 14" = 28 GAUGE

ASSEMBLED WITH 1/8" ZINC COATED RIVETS.

OPTIONS

AVAILABLE WITH DAMPERS

JOB: _____
 LOCATION: _____
 CONTRACTOR: _____
 ENGINEER: _____
 NOTES: _____