

PRODUCT SUBMITTAL 360

Product: **R-20 Connections for Brass Manifolds**
Date: **1 August 2013 (supersedes 14 October 2009)**

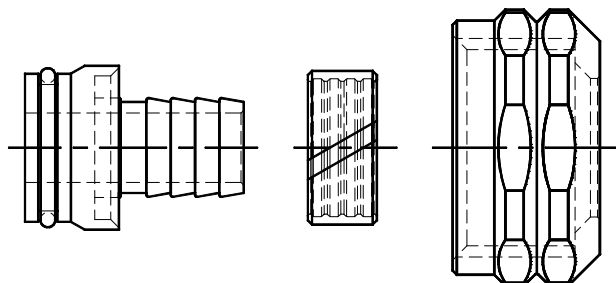

Article No.	Nominal Connection Size
267507	3/8 in. RAUPEX x R-20 Brass Manifold Outlet
261007	1/2 in. RAUPEX x R-20 Brass Manifold Outlet
267557	5/8 in. RAUPEX x R-20 Brass Manifold Outlet
267007	3/4 in. RAUPEX x R-20 Brass Manifold Outlet

TECHNICAL DESCRIPTION

Specification	ASTM F877, CSA B137.5
Material	Machined from brass rod
Certifications	ASTM F877, CSA B137.5

FUNCTIONAL DESCRIPTION

R-20 connections are for use with RAUPEX[®] crosslinked polyethylene (PEXa) pipes and PRO-BALANCE[®] and HLV brass heating manifolds, as well as with REHAU single circuit balancing and shut-off valve (Art. 260567). These compression nut-type connections install without special tools.

- 3/8, 1/2 and 5/8 in. fittings include barbed insert with installed O-ring, split brass ring and compression nut
- 3/4 in. fitting includes a R-20 x 1 in. NPS bushing, 3/4 in. barbed insert with installed O-ring, split brass ring and compression nut

Follow the detailed installation instructions that are included with the manifolds and summarized here:

1. After cutting the pipe square and clean, slide the nut over the end of the pipe. Push the split ring over the pipe and align it at the end.
2. Insert the barbed insert into the pipe, being sure to insert the fitting completely.
3. Align the fitting with the manifold outlet and push the fitting into the manifold.
4. Hand-tighten the compression nut onto the manifold outlet until it stops turning.
5. Finish tightening with a wrench, turning the nut no more than 1/2 turn after hand-tight.
6. Do not overtighten, as this may destroy the O-ring or distort the split ring. Be sure to check tightness after the first heat cycle(s).

For updates to this publication, visit na.rehau.com/resourcecenter

The information contained herein is believed to be reliable, but no representations, guarantees or warranties of any kind are made as to its accuracy, suitability for particular applications or the results to be obtained therefrom. Before using, the user will determine suitability of the information for user's intended use and shall assume all risk and liability in connection therewith.

© 2013 REHAU