



# PRESS FITTINGS FOR PLUMBING AND MECHANICAL APPLICATIONS

**JOB NAME**

**CONTRACTOR**

**JOB LOCATION**

**WHOLESALER**

**ENGINEER**

**STREAMLINE PRS™ REP**

## PRODUCT DESCRIPTION:

Streamline PRS™ mechanical press copper fittings for use in plumbing or mechanical applications. Available sizes ranging from 1/2" to 4" in diameter. Product is designed to join ASTM B88 (Types K, L, M) hard-drawn copper tube (1/2" to 4") and soft copper tube (1/2" to 1-1/4").

Integral leak featured design, allows for quick and easy identification of connections which have not been pressed prior to putting the system in operation.

Streamline PRS™ mechanical press fittings are compatible with most common pressing tools and jaws.

50 - Year Limited Warranty

## MATERIAL:

Streamline PRS™ components in a mechanical press copper fitting are: UNS C12200 Copper / K69300 low-lead brass for the body, EPDM o-ring, silicone o-ring lubrication, and stainless steel grip ring with a nylon spacer (2-1/2"-4" only).

## KEY SPECIFICATIONS:

Streamline PRS™ shall conform to material requirements of ASME B16.22, ASME B16.51, or ASME B16.18. Performance criteria of Streamline PRS™ mechanical press copper fittings shall conform to IAPMO PS-117 or ASME B16.51.

## INSTALLATION:

Product installation shall comply with the latest applicable building codes for the local jurisdiction and manufacturer's instructions.

## REFERENCES:

NSF/ANSI 61	Drinking Water System Components
NSF/ANSI 372	Lead Content Compliance
IAPMO PS-117	Press and Nail Connection
ASME B16.51	Copper and Copper Alloy Press-Connect Pressure Fittings
UPC	Uniform Plumbing Code
CSA TIL-MSE-13	

## TOOLS & INSTALLATION GUIDELINES

### TOOL & JAW COMPATIBILITY

#### 1/2" — 2"

Milwaukee M12 Tool w/Compact Jaws 1/2" — 1-1/4"  
 Milwaukee M18 Tool w/Standard Jaws 1/2" — 2"  
 NIBCO Mini Tool w/Mini Jaws 1/2" — 1"  
 NIBCO Standard Tool w/Standard Jaws 1/2" — 2"  
 REMS Mini Tool w/Mini Jaws 1/2" — 1-1/4"  
 REMS Standard Tools w/Standard Jaws 1/2" — 2"  
 Ridgid Compact Tools w/Compact Jaws 1/2" — 1-1/4"  
 Ridgid Standard Tools w/Standard Jaws 1/2" — 2"  
 Rothenberger Compact Tool w/Compact Jaws 1/2" — 1"  
 Rothenberger Standard Tools w/Standard Jaws 1/2" — 2"  
 Klauke UPA Tool w/Standard Jaws 1/2" — 2"  
 Klauke MAP Tool w/Mini Jaws 1/2" — 1-1/4"

#### 2-1/2" — 4"

Milwaukee M18 Tools w/Rings & Ring Jaw  
 REMS Standard Tools w/Rings & Z5 Adapter Tong  
 Ridgid Standard Tools w/ Rings & V2 Actuator Jaw

### DISTANCE BETWEEN JOINTS

#### PRESSING NEAR AN EXISTING PRESS CONNECTION

MINIMUM DISTANCE BETWEEN STREAMLINE PRS <sup>™</sup> JOINTS		
TUBE DIAMETER NOMINAL INCH	MINIMUM DISTANCE REQUIRED	
	INCH	MM
1/2"	—	—
3/4"	—	—
1"	—	—
1-1/4"	7/16"	10
1-1/2"	5/8"	15
2"	3/4"	20
2-1/2"	5/8"	15
3"	5/8"	15
4"	5/8"	15

### SOLDERING OR BRAZING NEAR AN EXISTING PRESS CONNECTION

The installer should take precautions to keep the press connection cool. These methods may include 1) wrapping the press connection with a cold wet cloth, 2) fabricating solder connections prior to installing the press fitting, or 3) applying spray-type cooling gels.

TUBE DIAMETER NOMINAL INCH	SOLDERING		BRAZING	
	MINIMUM DISTANCE		MINIMUM DISTANCE	
	INCH	MM	INCH	MM
1/2"	1-1/2"	38	4-1/2"	114
3/4"	2-1/4"	57	6-3/4"	172
1"	3"	76	9"	229
1-1/4"	3-3/4"	95	11-1/4"	286
1-1/2"	4-1/2"	114	13-1/2"	343
2"	6"	153	18"	457
2-1/2"	7-1/2"	191	22-1/2"	572
3"	9"	229	27"	686
4"	12"	305	36"	915

### PRESSING NEAR AN EXISTING SOLDERED OR BRAZED CONNECTION

TUBE DIAMETER NOMINAL INCH	MINIMUM DISTANCE	
	INCH	MM
1/2"	1/4"	7
3/4"	1/4"	7
1"	7/16"	11
1-1/4"	7/16"	11
1-1/2"	5/8"	16
2"	3/4"	19
2-1/2"	1/4"	7
3"	1/4"	7
4"	1/4"	7



**APPROVED APPLICATIONS FOR 1/2” TO 4” STREAMLINE PRS™:**

Types of Service	Comments	Pressure	Temperature	Compatible with EPDM Seal
<b>FLUIDS/WATER POTABLE</b>				
Hot and Cold Water	—	200 PSI	32°F to 250°F	√
Rainwater / Grey Water	—	200 PSI	-20°F to 250°F	√
Chilled Water	Ethylene Glycol / Propylene Glycol	200 PSI	-20°F to 250°F	√
Hydronic Heating	Ethylene Glycol / Propylene Glycol	200 PSI	-20°F to 250°F	√
Cooling Water	Up to 50% Ethylene Glycol or Propylene Glycol solution	200 PSI	-20°F to 250°F	√
Low-Pressure Steam	—	UP TO 15 PSI	248°F	√
<b>FUEL, OIL AND LUBRICANT</b>				
Ethanol	Pure Grain Alcohol	200 PSI	—	√
<b>GASES</b>				
Compressed Air	Less than 25mg/m <sup>3</sup> oil content	200 PSI	Up to 140°F	√
Oxygen - O <sub>2</sub> (non medical)	Keep oil and fat free/non-liquid O <sub>2</sub>	140 PSI	Up to 140°F	√
Nitrogen - N <sub>2</sub>	—	200 PSI	Up to 140°F	√
Argon	Welding Use	200 PSI	Up to 140°F	√
Hydrogen - H <sub>2</sub>	—	125 PSI	Up to 140°F	√
Vacuum	—	Max 29.2 inches of Mercury	Up to 140°F	√
Carbon Dioxide - CO <sub>2</sub>	Dry	—	Up to 140°F	√

**STREAMLINE PRS™ RECOMMENDED PRESSURE TESTING:**

Unpressed connections are located by pressurizing the system with air or water. When testing with water the proper pressure range is 15 PSI to 50 PSI maximum. Leak testing with air can be dangerous at high pressures. When testing with compressed air the proper pressure range up to 15 PSI maximum. Following a successful leak test, the system may be pressure tested up to 200 PSI if required by local code requirements or project specifications.

**SPECIFICATION LANGUAGE:**

Press Fitting: Shall conform to material requirements of ASME B16.22, ASME B16.51, or ASME B16.18. Performance criteria of mechanical pressed copper fittings shall conform to IAPMO PS-117 or ASME B16.51

- a. Operating pressure: 200 PSI CWP Max
- b. Temperature range: -20°F to 250°F
- c. EPDM sealing element, factory installed

-OR-

Mechanical pressed copper fittings. Jointing piping similar to Mueller Industries Streamline PRS™, Viega ProPress, or approved equal may be used.



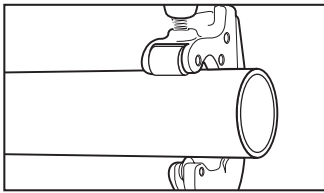

**1.** Cut tube square using a tube cutter or fine tooth saw.

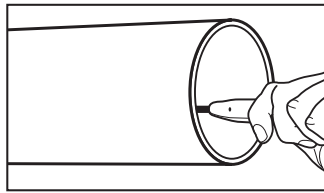

**2.** Deburr tube ID using a deburring tool.

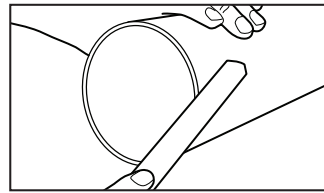

**3.** Deburr tube OD using half round file.

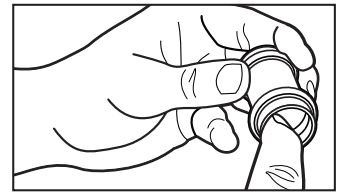

**4.** Check fitting bead to ensure seal is present. Do not use any type of oil lubrication.

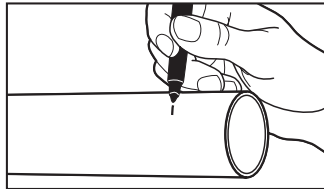

**5.** Mark tube to proper fitting insertion depth (see Insertion Depth Chart below).

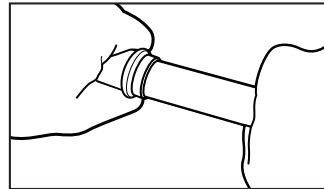

**6.** Turn slightly while sliding press fitting onto tube. Slide all the way to insertion mark and make contact with stop.

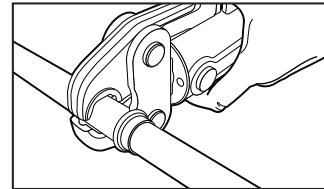

**7.** Place press tool at a right angle over fitting bead. Start the pressing process. Please see specific tool manufacturer for tool instruction.

Tube Size	1/2"	3/4"	1"	1-1/4"	1-1/2"	2"
Insertion Depth	3/4"	7/8"	7/8"	1"	1-7/16"	1-9/16"

Streamline PRS fittings must be connected with approved press tool. Please see specific tool manufacturer for tool instruction.

## Installation Instructions (2-1/2" - 4")

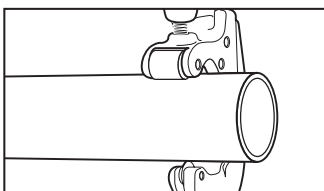

**1.** Cut tube square using a tube cutter or fine tooth saw.

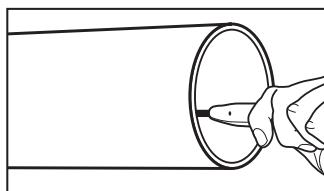

**2.** Deburr tube ID using a deburring tool.

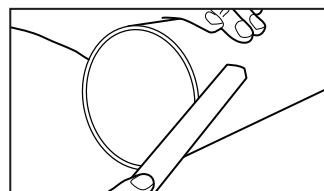

**3.** Deburr tube OD using half round file.

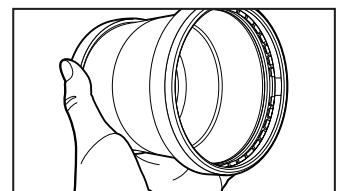

**4.** Check fitting ends to ensure seal, grip ring and nylon spacer are present. Do not use any type of oil lubrication.

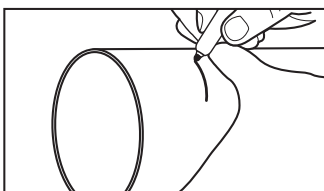

**5.** Mark tube to proper fitting insertion depth (see Insertion Depth Chart below).

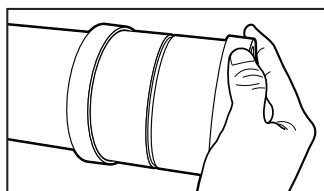

**6.** Turn slightly while sliding press fitting onto tube. Slide all the way to insertion mark and make contact with stop.

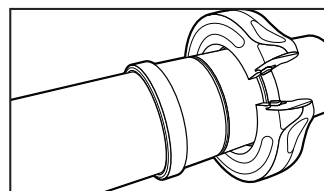

**7.** Place press-ring at a right angle over fitting bead and check for proper engagement. Re-check insertion depth.

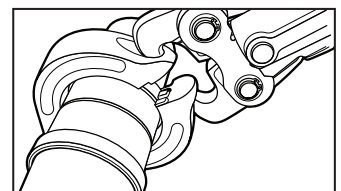

**8.** Start the pressing process. Please see specific tool manufacturer for tool instruction.

Tube Size	2-1/2"	3"	4"
Insertion Depth	1-3/4"	1-7/8"	2-1/8"

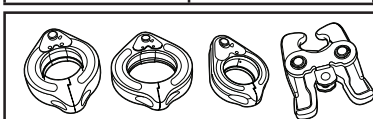

Large diameter (2-1/2" - 4") Streamline PRS fittings must be connected with approved press tool and press-rings. Please see specific tool manufacturer for tool instruction.

### ⚠ WARNING

Failure to follow all instructions could affect joint/system integrity and may lead to property damage. Call Customer Service at 1-800-FITTING if you have any questions or need assistance.

### 45° ELBOW • SMALL

P x P

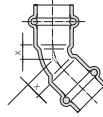

Item No.	Diameter	X	Wgt.	Inner	Viega No.
PF 03026	1/2"	0.31	0.08	10	77607
PF 03034	3/4"	0.37	0.15	10	77023
PF 03044	1"	0.45	0.21	5	77028
PF 03050	1-1/4"	0.51	0.29	1	77033
PF 03055	1-1/2"	0.59	0.58	1	77038
PF 03059	2"	0.79	0.81	1	77043

### 45° ELBOW • LARGE

P x P

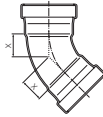

Item No.	Diameter	X	Wgt.	Inner	Viega No.
PF 03063	2-1/2"	1.30	1.74	1	20653
PF 03067	3"	1.57	2.27	1	20658
PF 03073	4"	2.07	4.10	1	20663

### 45° ELBOW • STREET • SMALL

FTG x P

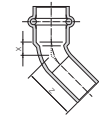

Item No.	Diameter	X	Z	Wgt.	Inner	Viega No.
PF 03326	1/2"	0.31	1.25	0.08	10	77637
PF 03334	3/4"	0.37	1.32	0.15	10	77053
PF 03344	1"	0.45	1.44	0.20	5	77058
PF 03350	1-1/4"	0.51	1.67	0.28	1	77063
PF 03355	1-1/2"	0.59	2.13	0.56	1	77068
PF 03359	2"	0.79	2.48	0.80	1	77073

### 45° ELBOW • STREET • LARGE

FTG x P

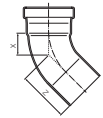

Item No.	Diameter	X	Z	Wgt.	Inner	Viega No.
PF 03363	2-1/2"	1.30	3.23	1.56	1	20668
PF 03368	3"	1.57	3.66	2.32	1	20673
PF 03373	4"	2.07	4.41	3.95	1	20678

### 90° ELBOW • DROP EAR • SMALL

P x FPT

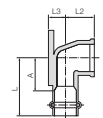

Item No.	Diameter	A	L	L2	L3	Wgt.	Inner	Viega No.
PF 01508	1/2"	0.94	1.88	0.90	0.85	0.21	5	79190
PF 02581	3/4"	1.12	2.02	1.05	1.06	0.29	5	79195

### 90° ELBOW • FEMALE • SMALL

P x FPT

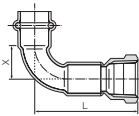

Item No.	Diameter	L	X	Wgt.	Inner	Viega No.
PF 01507	1/2"	1.71	0.76	0.18	5	79525
PF 01532	3/4"	2.16	1.04	0.31	5	79540
PF 01559	1"	2.55	1.31	0.40	5	79550
PF 01594	1-1/4"	3.02	1.65	0.68	1	79560
PF 01632	1-1/2"	3.42	2.55	0.97	1	79565
PF 01680	2"	4	2.61	1.63	1	79570

### 90° ELBOW • SHORT RADIUS • SMALL

P x P

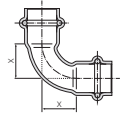

Item No.	Diameter	X	Wgt.	Inner	Viega No.
PF 01634	3/4"	0.75	0.18	10	77022
PF 01647	1"	1.22	0.28	5	77027
PF 02084	1-1/4"	1.22	0.35	1	77032
PF 02085	1-1/2"	1.24	0.63	1	77037
PF 02086	2"	2.05	1.07	1	77042

### 90° ELBOW • LONG RADIUS • SMALL

P x P

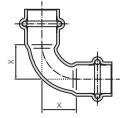

Item No.	Diameter	X	Wgt.	Inner	Viega No.
PF 02722	1/2"	0.72	0.11	10	77317
PF 02734	3/4"	1.04	0.21	10	77322
PF 02747	1"	1.32	0.27	5	77327
PF 02055	1-1/4"	1.65	0.40	5	77332
PF 02063	1-1/2"	2.00	0.70	5	77337
PF 02072	2"	2.62	1.10	1	77342

### 90° ELBOW • LONG RADIUS • LARGE

P x P

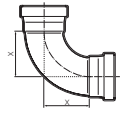

Item No.	Diameter	X	Wgt.	Inner	Viega No.
PF 02082	2-1/2"	2.99	2.09	1	20623
PF 02092	3"	3.62	2.10	1	20628
PF 02095	4"	4.74	5.61	1	20633

### 90° ELBOW • LONG RADIUS • REDUCING • SMALL

P x P

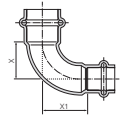

Item No.	Diameter	L3	X	X1	Wgt.	Inner	Viega No.
PF 02736	3/4" x 1/2"		1.02	1.26	0.19	15	77325
PF 02749	1" x 3/4"		1.30	1.54	0.30	10	77330

### 90° ELBOW • SHORT RADIUS • SMALL

P x FPT

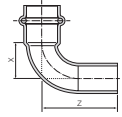

Item No.	Diameter	X	Z	Wgt.	Inner	Viega No.
PF 01654	3/4"	0.75	2.01	0.17	10	77052
PF 02344	1"	1.22	2.28	0.27	5	77057
PF 02384	1-1/4"	1.22	2.84	0.35	1	77062
PF 02385	1-1/2"	1.24	3.52	0.64	1	77067
PF 02386	2"	2.05	4.15	1.03	1	77072

### 90° ELBOW • LONG RADIUS • STREET • SMALL

FTG x P

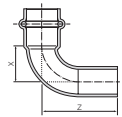

Item No.	Diameter	X	Z	Wgt.	Inner	Viega No.
PF 02822	1/2"	0.75	0.82	0.11	10	77347
PF 02834	3/4"	1.04	1.14	0.21	10	77352
PF 02847	1"	1.29	1.34	0.29	5	77357
PF 02350	1-1/4"	1.65	1.73	0.41	1	77362
PF 02355	1-1/2"	2.00	2.08	0.73	1	77367
PF 02359	2"	2.56	2.56	1.13	1	77372

**90° ELBOW • LONG RADIUS • STREET • LARGE**

FTG x P

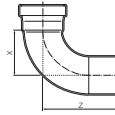

Item No.	Diameter	X	Z	Wgt.	Inner	Viega No.
PF 02363	2-1/2"	2.99	5.00	2.05	1	20638
PF 02368	3"	3.62	5.75	3.03	1	20643
PF 02395	4"	4.74	7.17	5.68	1	20648

**90° ELBOW • MALE • SMALL**

P x MPT

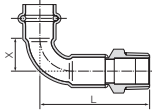

Item No.	Diameter	L	X	Wgt.	Inner	Viega No.
PF 01506	1/2"	1.5	0.78	0.18	5	-
PF 01531	3/4"	2.33	1.04	0.31	5	-
PF 01558	1"	2.81	1.31	0.42	5	-
PF 01593	1-1/4"	3.31	1.65	0.73	1	-
PF 01631	1-1/2"	3.7	2.01	1.17	1	-
PF 01679	2"	4.38	2.62	1.83	1	-

**ADAPTER • FEMALE • SMALL**

P x FPT

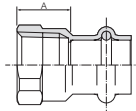

Item No.	Diameter	A	Wgt.	Inner	Viega No.
PF 01231	1/2"	0.96	0.15	5	79300
PF 01246	3/4"	1.10	0.24	5	79315
PF 01263	1"	1.20	0.35	5	79330
PF 01271	1-1/4"	1.28	0.53	5	79350
PF 01279	1-1/2"	1.38	0.82	1	79365
PF 01287	2"	1.37	1.12	1	79370

**ADAPTER • FEMALE • LARGE**

P x FPT

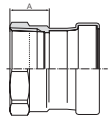

Item No.	Diameter	A	Wgt.	Inner	Viega No.
PF 01296	2-1/2"	1.42	1.25	1	20819
PF 01297	3"	1.54	1.85	1	20829

**ADAPTER • FEMALE • REDUCING • SMALL**

P x FPT

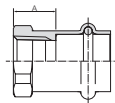

Item No.	Diameter	A	Wgt.	Inner	Viega No.
PF 01232	1/2" x 3/8"	0.53	0.09	10	79295
PF 01230	1/2" x 3/4"	1.72	0.22	5	79305
PF 01247	3/4" x 1/2"	1.56	0.18	5	79310
PF 01265	1" x 1/2"	0.73	0.29	10	79320
PF 01264	1" x 3/4"	1.69	0.26	5	79325
PF 01261	1" x 1-1/4"	1.16	0.48	10	79335
PF 01272	1-1/4" x 1"	1.88	0.38	5	79345
PF 01270	1-1/4" x 1-1/2"	1.28	0.62	1	79355
PF 01280	1-1/2" x 1-1/4"	1.26	0.38	1	79360

**ADAPTER • FEMALE • STREET • SMALL**

FTG x FPT

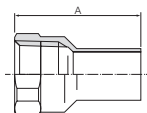

Item No.	Diameter	A	Wgt.	Inner	Viega No.
PF 15310	1/2"	1.59	0.09	5	79430
PF 01546	3/4"	1.90	0.15	5	79445
PF 01563	1"	1.96	0.23	1	79450

PF 01571	1-1/4"	2.17	0.32	1	79465
PF 01579	1-1/2"	2.63	0.49	1	79470
PF 01587	2"	2.84	0.75	1	79475

**ADAPTER • FEMALE • STREET • REDUCING • SMALL**

FTG x FPT

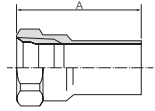

Item No.	Diameter	A	Wgt.	Inner	Viega No.
PF 01534	1/2" x 3/4"	1.87	0.13	5	79435
PF 01547	3/4" x 1/2"	1.81	0.15	5	79440
PF 01564	1" x 3/4"	1.85	0.20	5	-

**ADAPTER • MALE • SMALL**

P x MPT

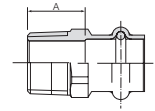

Item No.	Diameter	A	Wgt.	Inner	Viega No.
PF 01131	1/2"	1.11	0.15	5	79215
PF 01146	3/4"	1.26	0.23	5	79230
PF 01163	1"	1.62	0.35	5	79245
PF 01171	1-1/4"	1.64	0.53	5	79260
PF 01179	1-1/2"	1.65	0.70	1	79275
PF 01187	2"	1.73	1.17	1	79290

**ADAPTER • MALE • LARGE**

P x MPT

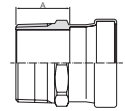

Item No.	Diameter	A	Z4	Wgt.	Inner	Viega No.
PF 01196	2-1/2"	1.97		1.62	1	20823
PF 01199	3"	2.17		2.23	1	20828
PF 01150	4"	2.40		3.82	1	20838

**ADAPTER • MALE • REDUCING • SMALL**

P x MPT

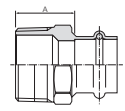

Item No.	Diameter	A	Wgt.	Inner	Viega No.
PF 01132	1/2" x 3/8"	0.75	0.08	10	79210
PF 01130	1/2" x 3/4"	1.88	0.23	5	79220
PF 01147	3/4" x 1/2"	1.70	0.20	5	79225
PF 01145	3/4" x 1"	1.19	0.30	10	79235
PF 01164	1" x 3/4"	1.85	0.28	5	79240
PF 01162	1" x 1-1/4"	2.31	0.51	5	79250
PF 01172	1-1/4" x 1"	2.15	0.38	5	79255
PF 01170	1-1/4" x 1-1/2"	2.34	0.65	1	79265
PF 01180	1-1/2" x 1-1/4"	1.62	0.63	1	79270
PF 01178	1-1/2" x 2"	1.67	1.00	1	79280
PF 01188	2" x 1-1/2"	1.58	0.92	1	79285

**ADAPTER • MALE • STREET • SMALL**

FTG x MPT

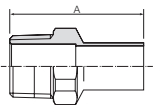

Item No.	Diameter	A	Wgt.	Inner	Viega No.
PF 01431	1/2"	1.75	0.10	5	79380
PF 01446	3/4"	2.02	0.17	5	79395
PF 01463	1"	2.15	0.27	5	79405
PF 01471	1-1/4"	2.44	0.40	1	79410
PF 01479	1-1/2"	2.90	0.59	1	79415
PF 01487	2"	3.15	0.88	1	79420

**ADAPTER • MALE • STREET • REDUCING • SMALL**

FTG x MPT

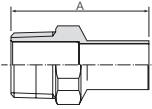

Item No.	Diameter	A	Wgt.	Inner	Viega No.
PF 01434	1/2" x 3/4"	2.05	0.18	5	79385
PF 01447	3/4" x 1/2"	1.95	0.16	5	79390
PF 01464	1" x 3/4"	2.03	0.20	5	79400

**CAP • SMALL**

P

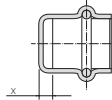

Item No.	Diameter	X	Wgt.	Inner	Viega No.
PF 07007	1/2"	0.10	0.05	10	77712
PF 07009	3/4"	0.11	0.10	10	77717
PF 07011	1"	0.11	0.11	5	77722
PF 07012	1-1/4"	0.11	0.15	1	77727
PF 07013	1-1/2"	0.12	0.28	1	77732
PF 07014	2"	0.13	0.41	1	77737

**CAP • LARGE**

P

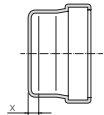

Item No.	Diameter	X	Wgt.	Inner	Viega No.
PF 07015	2-1/2"	0.33	0.68	1	20833
PF 07016	3"	0.33	0.97	1	20843
PF 07018	4"	0.39	1.67	1	20848

**COUPLING • CROSS OVER • SMALL**

P x P

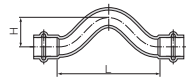

Item No.	Diameter	H	L	Wgt.	Inner	Viega No.
PF 02535	1/2"	1.10	3.62	0.24	10	77742
PF 02583	3/4"	1.34	4.57	0.41	10	77747

**COUPLING • CROSS OVER • STREET • SMALL**

FTG x P

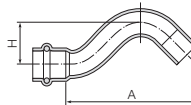

Item No.	Diameter	A	H	Wgt.	Inner	Viega No.
PF 12535	1/2"	2.93	0.94	0.23	10	-
PF 12583	3/4"	4.43	1.28	0.37	10	-

**COUPLING • NO STOP • SMALL**

P x P

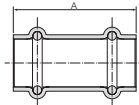

Item No.	Diameter	A	Wgt.	Inner	Viega No.
PF 01903	1/2"	1.93	0.07	10	78172
PF 01905	3/4"	2.36	0.13	10	78177
PF 01906	1"	2.34	0.17	5	78182
PF 01907	1-1/4"	2.58	0.23	1	78187
PF 01908	1-1/2"	3.39	0.44	1	78192
PF 01909	2"	3.70	0.61	1	78197

**COUPLING • NO STOP • LARGE**

P x P

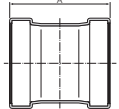

Item No.	Diameter	A	Wgt.	Inner	Viega No.
PF 01910	2-1/2"	3.54	1.08	1	20743
PF 01911	3"	3.86	1.45	1	20748
PF 01913	4"	4.49	2.42	1	20753

**COUPLING • NO STOP • EXTENDED • SMALL**

P x P

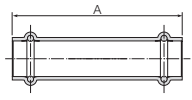

Item No.	Diameter	A	Wgt.	Inner	Viega No.
PF 01950	1/2"	2.95	0.13	5	79005
PF 01952	3/4"	3.35	0.20	5	79010
PF 01955	1"	3.74	0.30	5	79015
PF 01956	1-1/4"	4.13	0.38	1	79020
PF 01957	1-1/2"	4.72	0.70	1	79025
PF 01958	2"	5.31	0.94	1	79030

**COUPLING • STAKED STOP • SMALL**

P x P

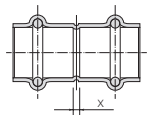

Item No.	Diameter	X	Wgt.	Inner	Viega No.
PF 10145	1/2"	0.24	0.07	10	78047
PF 10146	3/4"	0.39	0.13	10	78052
PF 10147	1"	0.39	0.17	5	78057
PF 10148	1-1/4"	0.39	0.23	1	78062
PF 10149	1-1/2"	0.47	0.44	1	78067
PF 10150	2"	0.47	0.61	1	78072

**COUPLING • STAKED STOP • LARGE**

P x P

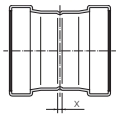

Item No.	Diameter	X	Wgt.	Inner	Viega No.
PF 10151	2-1/2"	0.16	1.08	1	20728
PF 10152	3"	0.16	1.45	1	20733
PF 10154	4"	0.16	2.42	1	20738

**COUPLING • REDUCING • SMALL**

P x P

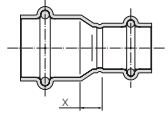

Item No.	Diameter	X	Wgt.	Inner	Viega No.
PF 01036	3/4" x 1/2"	0.39	0.12	10	78147
PF 01051	1" x 1/2"	0.53	0.16	10	15603
PF 01049	1" x 3/4"	0.43	0.15	5	78152
PF 01060	1-1/4" x 1/2"	0.71	0.20	1	-
PF 01058	1-1/4" x 3/4"	0.53	0.24	1	15593
PF 01056	1-1/4" x 1"	0.52	0.23	5	78157
PF 01069	1-1/2" x 1/2"	0.91	0.37	1	-
PF 01067	1-1/2" x 3/4"	0.75	0.39	1	18473
PF 01065	1-1/2" x 1"	0.71	0.37	1	15588
PF 01064	1-1/2" x 1-1/4"	0.37	0.39	1	78162
PF 01079	2" x 1/2"	1.28	0.55	1	-
PF 01077	2" x 3/4"	1.10	0.54	1	18468
PF 01075	2" x 1"	1.14	0.50	1	15608
PF 01074	2" x 1-1/4"	1.02	0.52	1	22328
PF 01073	2" x 1-1/2"	0.78	0.57	1	78167







**FLANGE • LARGE**

P x FLANGE

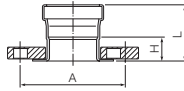

Item No.	Diameter	A	H	L	Wgt.	Inner	Viega No.
PF 02746	2-1/2"	5.51	1.26	2.95	6.26	1	20853
PF 02802	3"	5.98	1.26	3.11	8.06	1	20858
PF 01940	4"	7.52	1.38	3.54	11.18	1	20863

**FLANGE • LARGE**

FTG x FLANGE

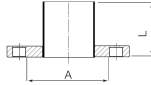

Item No.	Diameter	A	L	Wgt.	Inner	Viega No.
PF 12980	2"	3.75	6.00	6.500	1	-
PF 12746	2-1/2"	4.33	6.00	7.400	1	-
PF 12802	3"	5.01	6.00	8.500	1	-
PF 11940	4"	6.48	6.00	12.70	1	-